

23 Feb. 07

BULLETIN #207B

## CP113, CP114 AND CP117

### NEW COOLING FAN

The 415 volt cooling fan used in the Weldmatic 335, 395 and Fabricator (CP113, CP114 and CP117) has now changed to FAN005. Previously the CP44-0/2 fan was used in the Weldmatic 335, and FAN002 used in Weldmatic 395 and Fabricator.

There are 2 major differences in the new fan that must be taken into consideration when fitting it as a replacement.

- The cowling around the fan blades is deeper than the original. This means some components inside the power source may need to be shifted to allow sufficient clearance.
- There is a capacitor fitted to the wiring on the new fan. This is an essential part of the new fan, and must be left connected. The body of this capacitor must be securely mounted so that the wiring is not carrying the weight of the capacitor.

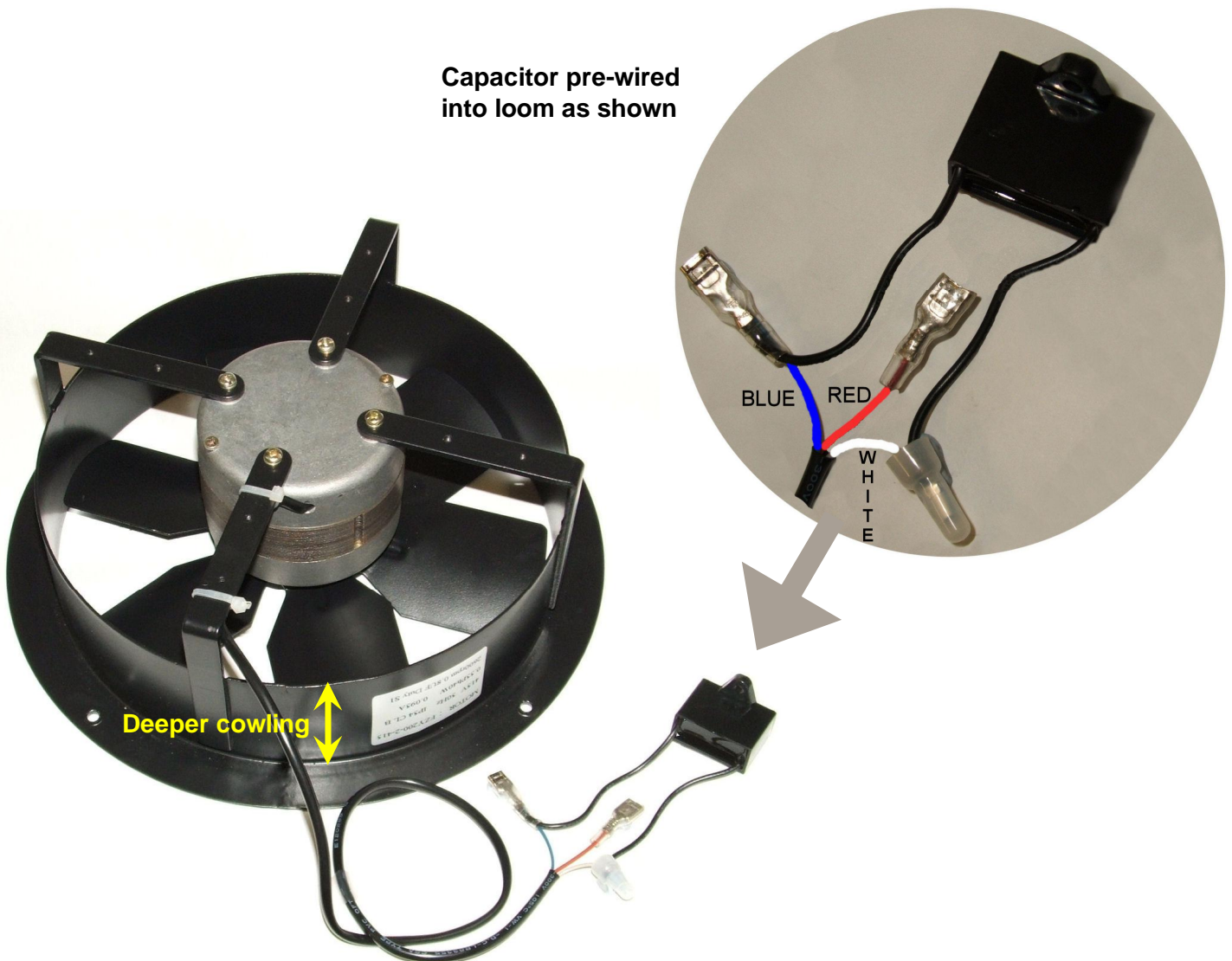

**QUALITY WELDING PRODUCTS, SYSTEMS AND SERVICES**

The information provided in this sheet is accurate and reliable, however no warranty of accuracy or reliability is given and no responsibility arising in any other ways by errors or omissions is accepted. Any information involving mains or high voltage is intended for use by qualified electrical personnel only.

**Replacement Spare Parts**

The new fan can be fitted to machines which had originally been fitted with the earlier fans by carrying out these modifications:

1. For Weldmatic 335 and 395, the control transformer will need to be shifted to make clearance for the deeper cowling of the new fan. Drill a new 7mm dia. hole for the control transformer fixing screw, 25mm closer to the side.
2. Secure the new fan using the existing screws. This will more easily be done if all the screws are started before finally tightening any of them up.
3. Connect the fan wires to the existing fan wiring using insulated connectors. The polarity is not critical, but the capacitor must remain connected to the same wires as originally supplied (refer photo on page 1).
4. Securely mount the capacitor to either the fan supports or the machine frame (depending on model and existing wiring). This may be via a 3mm self tapping screw or cable ties.
5. Ensure the wiring is securely affixed using cable ties.

Hugh Stewart,  
Technical Service Coordinator